

# BugSource.com

Providing Bug Control Solutions That Work!  
Bug Source LLC

## ThermaCELL®

## MOSQUITO REPELLENT

# Patio Lantern

### DIRECTIONS FOR USE

It is a violation of Federal law to use this product in a manner inconsistent with its labeling.

For best results allow 10 to 30 minutes, depending upon area, for product to take effect. This product works well in outdoor areas where there is minimal air movement, such as decks, unenclosed porches, patios and yards. It is also great for camping. Use one lantern per each 225 square feet (an area 15'x 15') or 15' in diameter. Use more lanterns in larger areas. Do not expose lanterns or mats to rain. Cover or remove all exposed food. Do not leave lantern unattended or use in windy conditions. No open flame. Lantern provides light and repels mosquitoes, black flies, flying insects, bugs and biting flies. Batteries power the light; heat from the ThermaCELL® cartridge activates the repellent mat and provides mosquito repellency for an area the size of an average deck. Simply insert the cartridge, push the button and enjoy the outdoors for hours. **Use Restrictions:** Only for outdoor use as an insect repellent. Do not use indoors, in tents or in any enclosed area. Do not insert anything other than ThermaCELL® mats into the lantern. Place lantern on a flat, stable surface with the grill facing upward. Clean with a damp cloth only when the lantern is cool and inactive. Butane cartridges other than ThermaCELL® cartridges will not work in this lantern. Seller will not be held responsible for damage, injury or poor performance caused by use of other butane cartridges or repellent mats.

**1.** Remove the battery cover on the bottom. Install 4 AA-size batteries, making sure that the batteries are correctly placed in the indicated directions. Replace battery cover. The batteries will provide lantern light for up to (a maximum of) 200 hours on the "LO" setting and up to (a maximum of) 150 on the "HI" setting.



**2.** Remove one ThermaCELL® mat from wrapper. Mats last up to (a maximum of) 4 hours. Mat turns from pale blue to white when repellent has been exhausted.



**3.** Make sure the 'ON/OFF' button is in the 'OFF' position. Insert the mat under the grill at the top of the lantern.



**4.** Remove top of lantern and globe from base by squeezing the latch tabs and removing the top of lantern until it is fully removed from the base.



**5.** Remove the butane cartridge cap. Screw the cartridge into the center of the lantern globe. Make sure the cartridge is fully inserted by turning it clockwise until it stops. Replace lantern globe on base. One ThermaCELL® butane cartridge lasts up to (a maximum of) 12 hours.

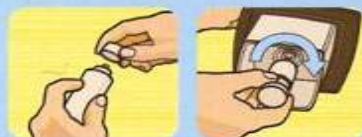

**6.** To turn on lantern light, push the black switch located on the base of the lantern. Push the switch to 'LO' for low light, 'HI' for bright light and 'OFF' to turn off the light. If lantern light does not turn on, replace batteries.



**7.** The lantern may be used as a mosquito repellent with or without the light being on. However, for the lantern to repel mosquitoes and flying insects, the mosquito repellent must be activated. To activate the mosquito repellent, slide the 'ON/OFF' button to the 'ON' position. The gas will begin to flow.



**8.** Wait approximately 5 to 10 seconds and then depress the 'START' button three to five times in rapid succession.



**9.** To verify that the mosquito repellent is activated, look in the circular view hole located at the top of the lantern. An orange light will glow. If there is no orange light, check to make sure the lantern is 'ON' and the cartridge is completely screwed into place. Also check the fuel level in the cartridge. If the fuel level in the cartridge is empty or near empty, remove cartridge and replace with a new ThermaCELL® cartridge. Then once again turn the lantern 'ON' and depress the start button three to five times in rapid succession. Check again to make sure the orange light is glowing.



**10.** Place the lantern on a flat stable area with the grill facing up. Do not touch the grill; it will be hot after a few minutes. Some visible vapor will appear during use. This is normal. When finished using the lantern, slide the 'ON/OFF' button to the 'OFF' position. If using the light, push the light switch to 'OFF' to extinguish the lantern light. Allow lantern to cool completely. Lantern is now ready for storage.

**11.** To replace a used mat, turn off lantern and allow to cool completely. Push the used mat out by inserting a fresh mat.



### STORAGE AND DISPOSAL:

Do not contaminate water, food or feed by storage or disposal.

**Storage:** Store unused mats in original packaging in a cool, dry place inaccessible to children and pets. Store lantern and butane cartridges in a cool, dry place away from sources of heat.

**Disposal:** If cartridge is empty or for used mats: Do not reuse empty packaging, wrappers or cartridges. Do not puncture or incinerate empty cartridges. Place in trash or offer for recycling if available. If cartridge is partly filled or for unused mats: Call your local solid waste agency for disposal instructions. Never place unused mats down any indoor or outdoor drain.